

Exposition Point

110 FREEWAY AT MARTIN LUTHER KING BLVD. & FIGUEROA ST. | LOS ANGELES , CA



NEWMARK

EXPOSITION POINT

Property Features

- Approved development plan (City of Los Angeles)
- Attractive infill location
- Freeway visibility and access (on/off ramps)
- Nearby Exposition Line (Metro)
- Directly across from Banc of California Stadium
- Opening in 2024

CONTACT:

Bryan Norcott

t 213-298-3595

bryan.norcott@nrmk.com

CA RE Lic. #01200077

Norman Lee

t 213-596-2242

norman.lee@nrmk.com

CA RE Lic. #01374832



EXPOSITION POINT



EXPOSITION POINT



NEWMARK

EXPOSITION POINT

Site Plan

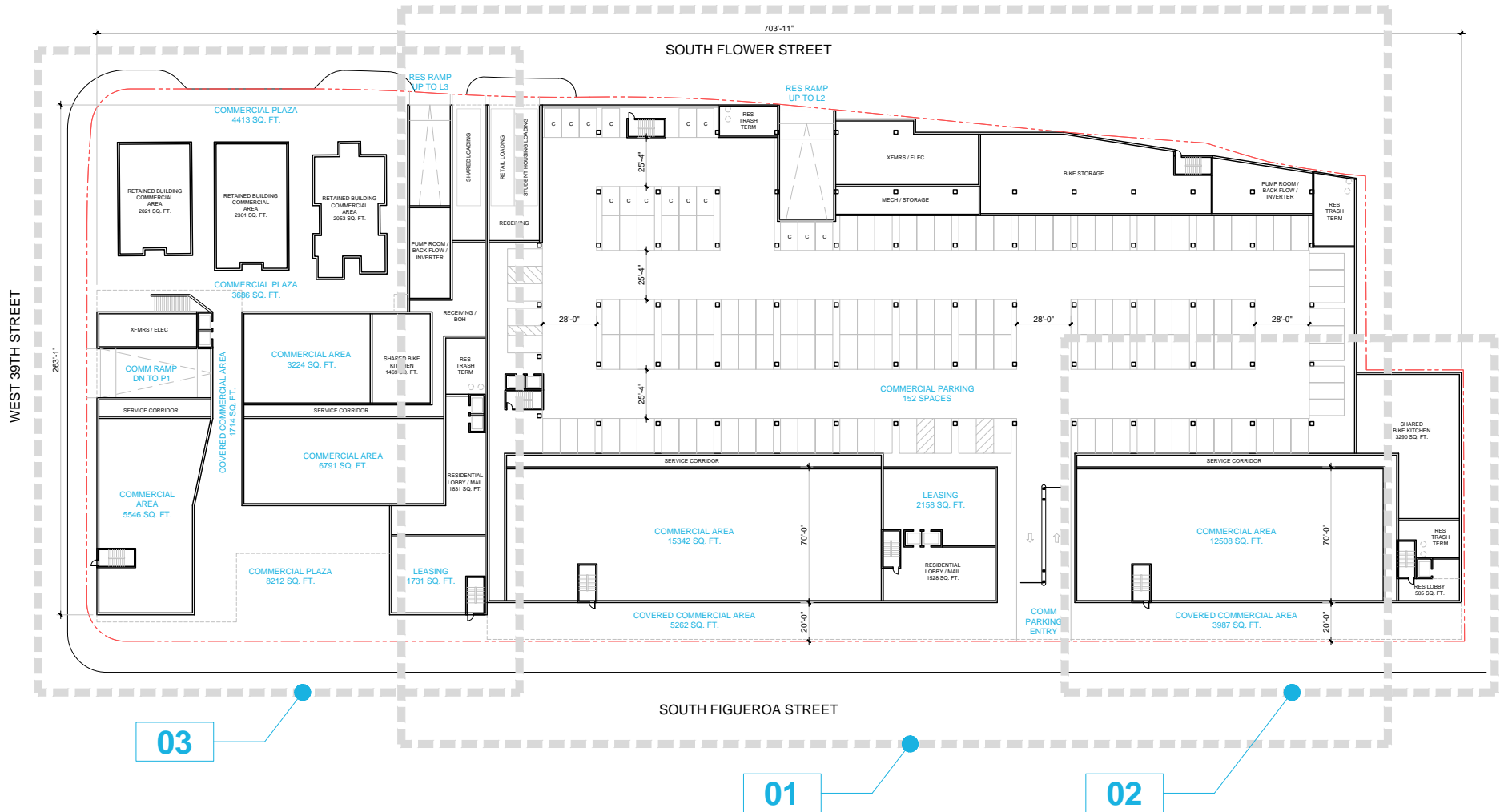

EXPOSITION POINT

Site Area

4.4
ACRES

252
HOTEL ROOMS

252
STUDENT HOUSING

84,000
SF OF RESTAURANTS,
RETAIL & CREATIVE OFFICE

78
MULTIFAMILY UNITS
(66 AFORDABLE)

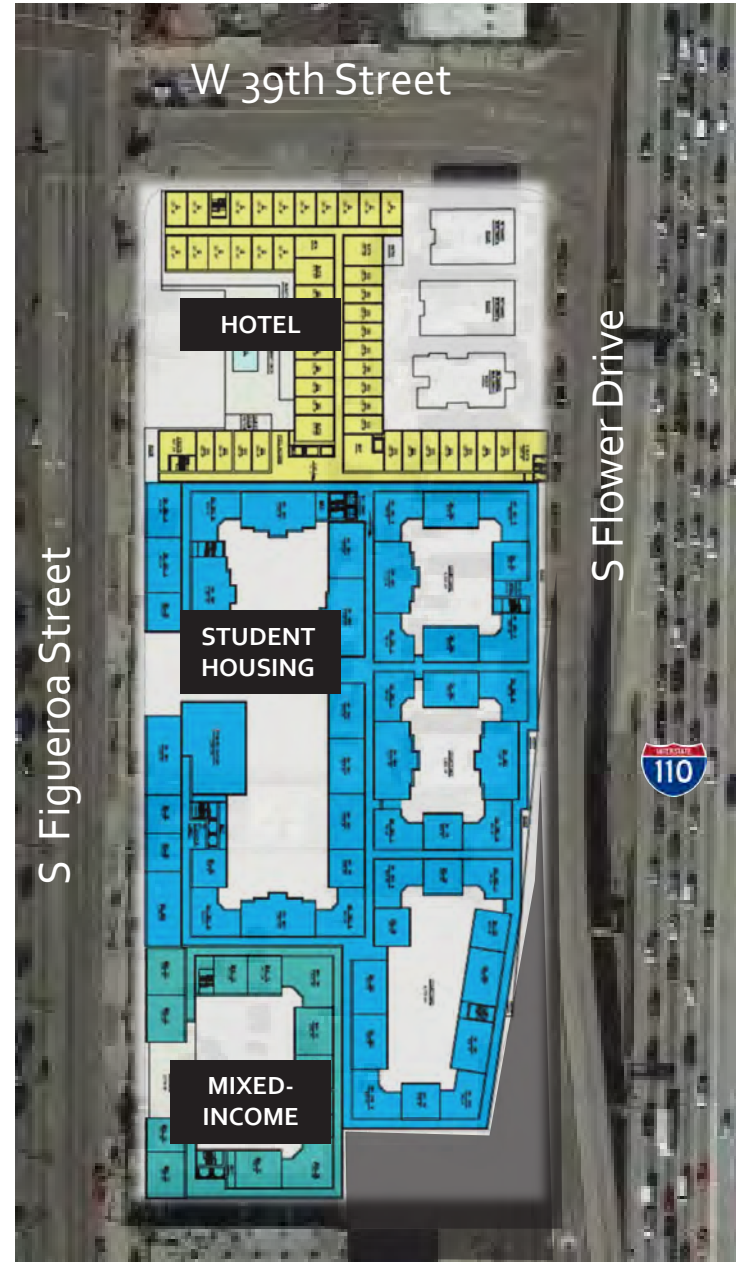

EXPOSITION POINT



For More Information Contact:

Bryan Norcott

Executive Managing Director
t 213-298-3595
bryan.norcott@nrmk.com
CA RE Lic. #01200077

Norman Lee

Senior Managing Director
t 213-596-2242
norman.lee@nrmk.com
CA RE Lic. #01374832

DTLA Office

700 S. Flower St, Suite 2500
Los Angeles, CA 90017
Corporate License #01355491

NEWMARK

The information contained herein has been obtained from sources deemed reliable but has not been verified and no guarantee, warranty or representation, either express or implied, is made with respect to such information. Terms of sale or lease and availability are subject to change or withdrawal without notice.

nrmk.com